



FW FORMSAVER



### RHINO FW Formsaver

The RHINO FW Formsaver Assemblies effectively address the challenge of splicing rebar in segmental concrete construction. RHINO Formsavers eliminate the need to drill holes in expensive formwork for extending dowel bars. RHINO Formsavers are available in sizes #4 thru #7 as a 2- part system (male DI/female DB) assembly. The coupler is friction welded to the bar, so there is no additional field assembly. The male threaded bar comes with a plastic end cap to protect the threads, and the female coupler comes with a removable metal cap to protect the interior of the coupler until final assembly.



### Features and Benefits

- Meets and exceeds ACI 318 Type 1 (125% Fy) and Type 2 (100% Fu)
- Eliminates drilling holes in formwork
- Eliminates trip hazard of protruding dowel bars
- Tapered thread is self aligning, eliminates cross threading, and is fast to install
- Maintains structural integrity and strength of rebar across construction joints
- Available in Black and Epoxy

### Typical Applications

- Bridge deck segmental construction
- Slurry Walls, columns to beams, core wall, shear wall
- Crane and temporary construction openings
- Stadiums, high rise buildings, wastewater treatment plants, parking garages





FW FORMSAVER

## TYPICAL CONFIGURATIONS

### RHINO Female Configurations

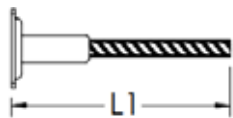

RFW1

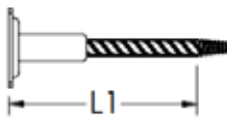

RFW2

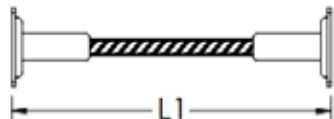

RFW3

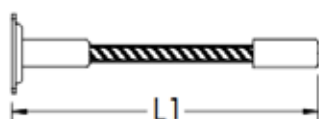

RFW4

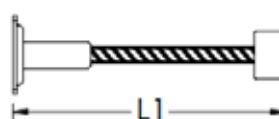

RFW5



RFW6

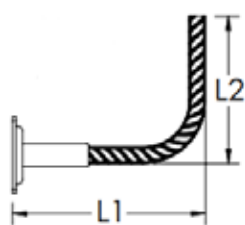

RFW7

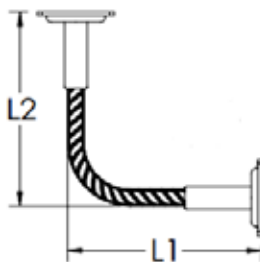

RFW8

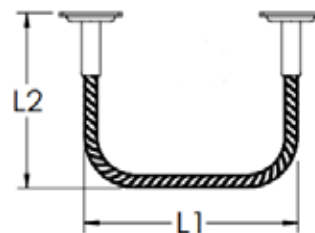

RFW9

### RHINO Male Configurations

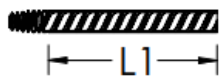

RM1

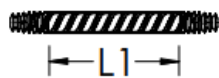

RM2

### RHINO Formsaver Dowel Bar System Manufacturing Centers

#### Summit Engineered Products

516 Elm Ridge Ave  
Canal Fulton OH 44614  
Phone 330-854-5388